

Customizable LiDAR Sensing Solutions  
For High Security Applications

# REDSKAN Series

The REDSCAN Product Series utilizes LiDAR sensing technology to provide highly accurate detection of intruders and moving objects. Equipped with OPTeX's most advanced technologies, it provides excellent detection performance not affected by variable lighting, temperature, or environmental changes, making it the ideal solution for high security sites.

**Applications include:**

Power plants, substations, border protection, correctional facilities, data centers, distribution centers, airports, water treatment plants, ports, warehouses, museums & art galleries, financial institutions, hospitals, and schools.



RLS-2020 Series



REDSKAN Pro Series



RLS-3060 Series

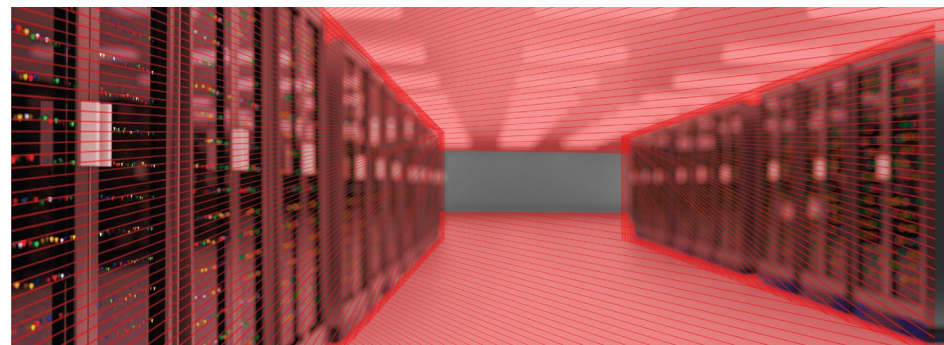

# Specialized Laser Detectors for High Security Applications

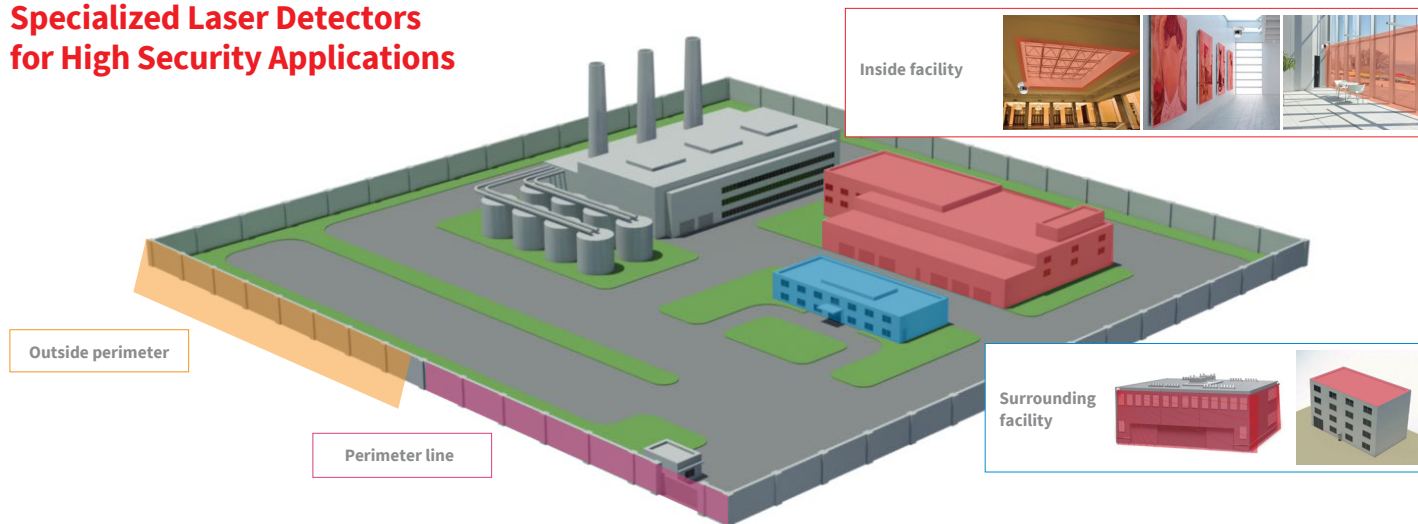

## RLS-3060 Series



The RLS-3060 series is an innovative laser scan detector that identifies a moving object's size, speed, and distance from the detector. It processes that information with a unique algorithm, providing a highly reliable detection system with minimal false alarms.

### FEATURES

- 30m (100ft) radius for 190 degrees range
- Vertical and horizontal mounting
- Unique detection algorithm
- Automatic area setting function
- 4 independently adjustable detection areas and 4 linked outputs for PTZ camera control (on Analog connection and IP connection)
- Fog cancellation algorithm (Patent listed)

### RLS-3060L

- Scene selection ( Indoor / outdoor)

### RLS-3060SH

- Scene selection(outdoor, indoor, indoor ceiling/Wall protection and vehicle)
- 8 independently adjustable detection area and Redwall event codes for network recorder and video management software (on analog connection and on IP connection)
- Built-in heater

### VERTICAL DETECTION ZONE

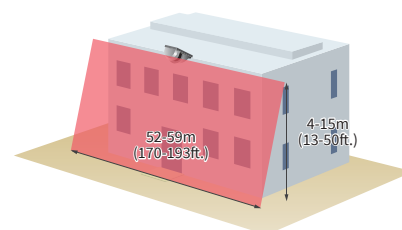

### HORIZONTAL DETECTION ZONE

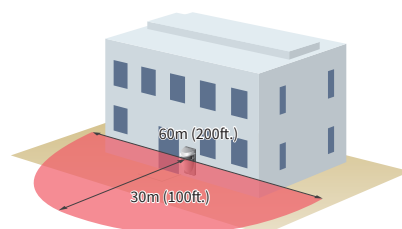

## RLS-2020 Series



The RLS-2020 series is a compact and highly customizable Laser Scan detector that works in an unobstructed way to protect houses, buildings, flat roofs, controlled areas, and assets, by creating an invisible laser wall or plane and detecting any intrusion breaching it.

### FEATURES

- 20m x 20m (65ft. x 65ft.), 95 degree detection area
- Vertical and Horizontal detection modes
- Multi-angle Adjustment Shell Structure (M.A.S.S.)
- Unique detection algorithm
- Automatic area setting function
- Advanced area setting
- 4 adjustable detection areas on IP connection
- Total 3 outputs can be assigned for analog connection

### RLS-2020I

- Indoor use model

### RLS-2020S

- Indoor / outdoor mode
- Indoor high resolution mode
- Indoor throw-in mode

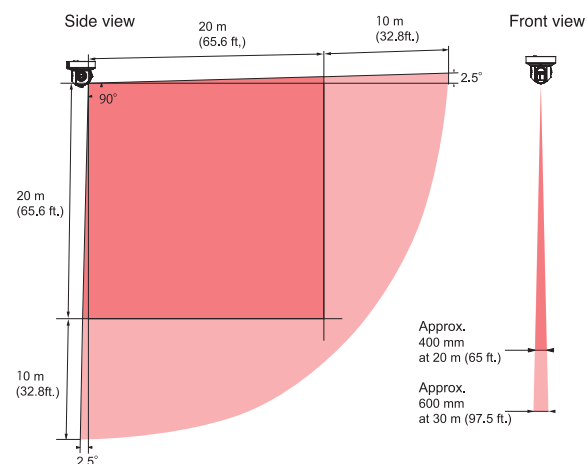



## REDSKAN Pro Series

The REDSCAN PRO series can very accurately detect intruders to a range of 165 x 330ft (50 x 100m), without any gaps and keeping the same detection resolution near and far into the detection range. Equipped with OPEX's most advanced technology, the REDSCAN PRO provides excellent detection performance that won't be affected by variable lighting, temperature or environmental changes, making it the best solution for high security sites.



### FEATURES

- RLS-50100V:** 50 x 100 m (approx. 165 x 330 ft.)
- RLS-3060V:** 30 x 60 m (approx. 100 x 200 ft.)
- Very high detection resolution: 0.125°
- Vertical and horizontal mounting
- Selectable installation method (wall, ceiling, pole mount)
- Rectangular detection area
- 8 independent detection zones with customizable target size, sensitivity, and output
- Embedded video camera for visualizing your detection area
- Event log function — Confirm events with event log & image
- Auto area adjustment
- Small animal tolerant
- Setting by Internet browser
- Environmental resistance function

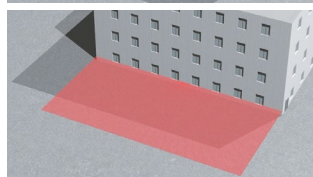
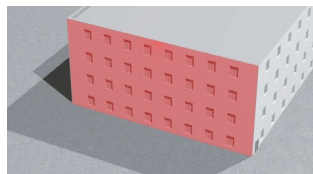
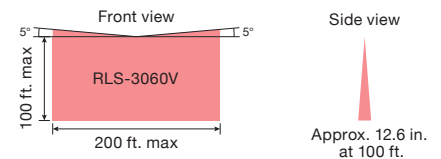
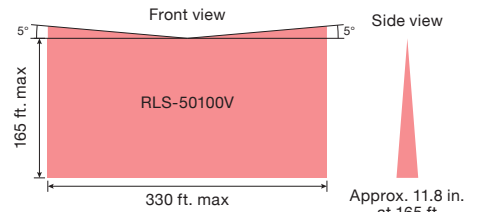

### RLS-3060V

- Indoor / outdoor model
- 8 independent detection zones. Configurable sensitivity, target size & output

### RLS-50100V

- Indoor / outdoor model
- Expanded mode: up to 530 ft vertical / 265 ft radius horizontal mount
- 8 independent detection zones. Configurable sensitivity, target size & output

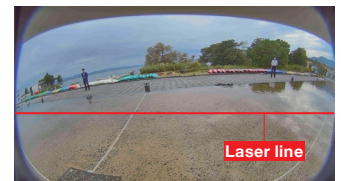

The REDSCAN Pro LiDARs are ONVIF profile S conformant sensors allowing them to send alarm outputs via the ONVIF protocol to any ONVIF conformant networked video system or IP network devices.

### Detect a crawling person



### Detect a running person



### Thrown object detection



### Quick intrusion detection

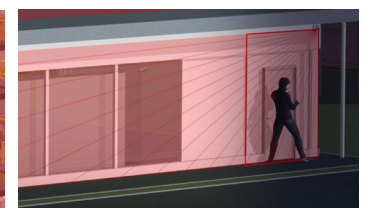

## SPECIFICATIONS

Model	RLS-3060SH	RLS-3060L
Detection method	Infrared Laser Scan	
Laser protection class	Class 1	
Coverage	Vertical area	Max. 100m (s), 60 m (i), at 10% reflectivity
	Horizontal area	Radius:50m (s), 30 m (i), Arc:190° at 10% reflectivity
Detection resolution	0.25°	
Communication port	Ethernet ,RJ-45 ,10BASE-T/100BASE-TX	
Protocol	UDP, TCP/IP *Redwall Event Code	
Power input	24 VDC , 24 VAC	
Current draw	400 mA max. (24 VDC) 600 mA max. (24 VAC)	
Heater power input	24 VDC, 24 VAC	-
Heater current draw	400 mA max. (24 V DC/AC)	-
Mounting height	Vertical area	From 4 m (13 ft.) to 15 m (50 ft.) (recommendation)
	Horizontal area	0.7 m (28 in.) (recommendation)
Target object selector	S / M / L	
Sensitivity selector	H / M / L	
Camera control output	N.O. 28 VDC, 0.2 A x 4 outputs	
Master alarm output	Form C, 28 VDC, 0.2 A max.	
Trouble output	Form C, 28 VDC, 0.2 A max.	
Tamper output	N.C. 28 VDC, 0.1 A max.	
Environmental disqualification circuit	Form C, 28 VDC, 0.2 A max.	
Alarm period	Approx. 2 sec., Off delay timer	
Operating temperature	-20 to 60 °C (-4 to 140° F)	
Operating temperature with heater	-40 to 60 °C (-40 to 140° F)	-
IP rating	IP66	
Dimensions (H x W x D)	334 x 144 x 155 mm (13.2 x 5.7 x 6.1 in.)	
Weight	2.5 kg (88 oz)	2.4 kg (85 oz)

Model	RLS-2020I	RLS-2020S
Installation location	Indoor	Indoor/Outdoor
Detection method	Infrared Laser Scan	
Laser protection class	Class 1	
Power input	10.5 to 30 VDC, PoE (IEEE802.3af/at compliant)	
Current draw	500mA max. (12 VDC), 250mA max. (24 VDC), 6W max. (PoE)	
Mounting method	Ceiling mount, Wall mount, Tripod mount, Pole mount (option), Recess mount (option)	
Detection area	S: 30m (97.5ft) radius arc   i: 20 x 20 m, (approx. 65 x 65 ft.)   95 degrees	
Detection range	Radius 1 to 21m (approx. 3.0 to 68 ft.) at 10% reflectivity	
Detection resolution / Response time	0.25 degrees / within 75 ms to 1 minute	0.25 degree / within 75msec to 1 minutes (for indoor mode and outdoor mode) 0.25 degree / within 25msec (for indoor throw-in mode), 0.125 degree / within 100msec to 1 minutes (for Indoor high resolution mode)
Mounting height (Mounting mode)	2 m (6.7 ft.) or higher	Indoor: 2 m (6.7 ft.) or higher Outdoor: 4 m (13 ft.) or higher (Recommended)
Communication port	Ethernet RJ-45 10BASE-T/100BASE-TX (Auto negotiation)	
Protocol	UDP, TCP/IP (Redwall Event Code), Http (Web setting), SNMP	
Output	3 outputs, 28 VDC 0.2A max. N.O./N.C. Selectable (3 from Master alarm, Zone outputs, Trouble, Tamper)	3 outputs, 28 VDC 0.2A max. N.O./N.C. Selectable (3 from Master alarm, Zone outputs, Trouble, Tamper, D.Q.)
Input	-	1 Non-voltage contact input
Alarm period	Approx. 2 sec delay timer	
Operating temperature	-40 to 50 C degrees (-40 to 122 F degrees)	-40 to 60 C degrees (-40 to 140 F degrees)
IP rating	IP66	
Dimensions (HxWxD)	146 x 160 x 160 mm (5.8 x 6.3 x 6.3 inch)	
Weight	1.0 kg (2.2 lb)	

Model	RLS-50100V	RLS-3060V
Installation location	Indoor / Outdoor	
Detection method	Infrared Laser Scan	
Laser protection class	Class 1	
Power input	19.2-30 VDC, PoE+ (IEEE 802.3at compliant)	
Current draw	500 mA max. (24 VDC), 12 W max. (PoE+)	
	with heater option: 1.25 A max. (24 VDC), 25.5 W max. (PoE+)	
Mounting method	Ceiling mount, Wall mount, Pole mount	
Detection area	50 x 100 m, 190 degree (approx. 165 x 330 ft.)	30 x 60 m, 190 degree (approx. 100 x 200 ft.)
Detection range	Radius 1 to 50 m (approx. 3.3 to 165 ft.) at 10% reflectivity	Radius 1 to 30 m (approx. 3.3 to 100 ft.) at 10% reflectivity
Detection resolution / Response time	0.125 degrees / within 100 msec. to 15 min.	0.25 degrees / within 100 msec. to 15 min.
Mounting height (Vertical mode)	Indoor: 2 m (approx. 6.7 ft.) or higher/Outdoor: 4 m (approx. 13 ft.) or higher (Recommended)	
Communication port	Ethernet RJ-45 10BASE-T/100BASE-TX (Auto negotiation)	
Protocol	UDP/TCP/HTTP/HTTPS/IPV4/DNS/DHCP/SNMPv1-v3/NTP/WS-Discovery/ONVIF	
Output	6 outputs, 28 VDC 0.2A max. N.O./N.C. Selectable	
Input	1 Non-voltage contact input	
Alarm period	Approx. 2 second delay timer	
Operating temperature	-20°C to 60°C (-4°F to 140°F)	
	with RLS-LWVH: -40 °C to 60°C (-40°F to 140°F)	
Dimensions (HxWxD) , Weight	230 x 160 x 256.6 mm max. (9.1 x 6.3 x 10.1 inch), 2.6 kg (92 oz.)	
IP rating	IP66	

\*ONVIF is a trademark of Onvif, Inc. [www.onvif.org/profiles/profile-s/](http://www.onvif.org/profiles/profile-s/)

## OPTIONS



**2020-PDMA**  
Pendant Mount



**RLS-SB**  
Adjustable angle mounting bracket for RLS-3060 series



**2020-MAB**  
Multi-Angle Adjustment Wall Ceiling Mount



**LAC-1**  
Laser Area Checker



**RLS-RB**  
Recess mount bracket



**2020-WMA**  
12" wall mount arm bracket

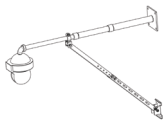

**2020-WMAD**  
Adjustable Extension Wall/Roof



**RLS-LWV**  
Replacement Window for RLS-3060V & RLS-50100V



**RLS-LWVH**  
Replacement Window with heater unit for RLS-3060V & RLS-50100V

For more information about the REDSCAN Series  
Please contact us at:

800.966.7839  
[sales@optexamerica.com](mailto:sales@optexamerica.com)